

Attach light gauge sheet metal to sheet metal in HVAC or any light duty steel applications with speed and precision, using our **Professional-Grade Strong-Point Razor**.

Features

- Multipurpose sheet metal screw for light to medium gauge applications
- 20° point pierces light gauge metal quickly
- Razor non-walking point for faster engagement
- Hi-Hex head provides deeper tool engagement for improved drivability



Headmarked for traceability

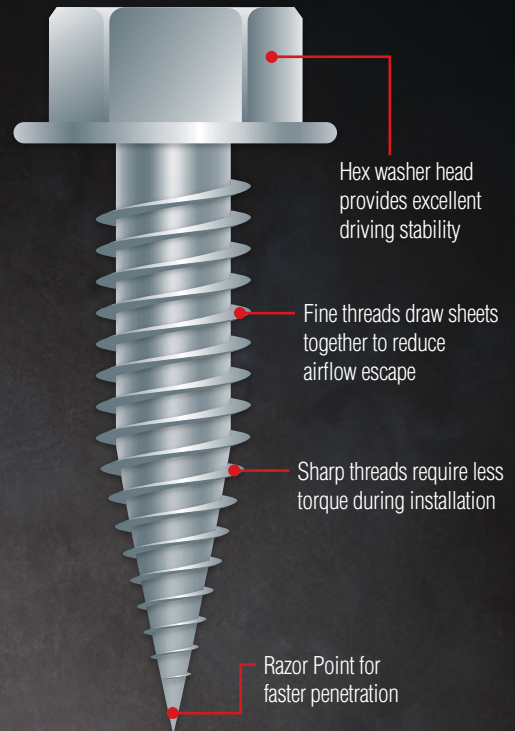

Hex washer head provides excellent driving stability

Fine threads draw sheets together to reduce airflow escape

Sharp threads require less torque during installation

Razor Point for faster penetration

Unslotted Indented Hex Washer Head, Fine Thread, Razor Point, Zinc Plated

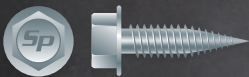

- Meets ASTM A 510 for carbon steel manufacturing
- Zinc plating meets ASTM B 633 for electrodeposited zinc coatings

Material Application

Attaches light gauge sheet metal to sheet metal.

Size	Bulk Part No	Bulk Qty	Lbs*	Head Size	5lb Part No	5lb Qty	1lb Part No	1lb Qty
8-32 x 1/2*	NU808	10M	34	1/4" A.F. #8 Head	NU808V	1,500	NU808I	300
10-24 x 3/4**	NU1012H	5M	38	5/16" A.F. #10 Head	NU1012V	625	NU1012I	125

*Hex Washer Head w/Serrations **Hi-Hex Head Washer Head